

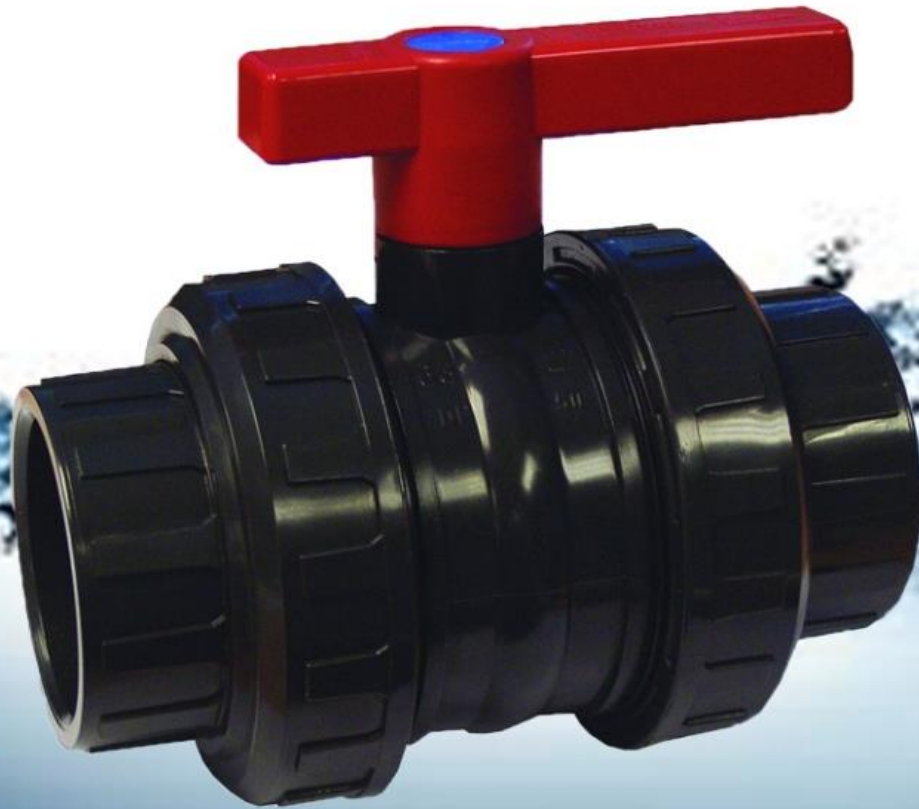

TRUE UNION BALL VALVES

Finger Tip Flow Control



Primerus True Union ball valves and PVC butterfly valves are manufactured by CEPEX, a global supplier with an extensive track record in US farming and nursery applications. The CEPEX ball valve is a premium product offering true union functionality at a competitive price that was designed for agriculture.

While a common “compact” ball valve can be effective when the opening is set once then rarely if ever changed, the CEPEX valve is ideal for applications where the opening must be changed on a daily basis. A highly polished ball and spring loaded seat allow for effortless turning of the handle with one hand – even when under pressure. Close tolerance HDPE seats keep the ball clean, so the handle continues to turn easily throughout the long life of the valve.

Another unique feature of the CEPEX valve is its serviceability. Being a true union valve it can be removed from the system without cutting pipes. Once removed, it can be easily disassembled to remove debris or replace seals or other parts. If the valve body becomes badly damaged for any reason it can be easily replaced, without major disassembly of the system.

CEPEX ball valves are ideal for your high-end nursery applications. Spanning a range from ½” to 4”, the line includes the right part for your operation, regardless of size.

Primerus Products, LLC is dedicated to supplying product solutions to progressive nursery growers. Visit us at PrimerusProducts.com or contact us at 1-855-SPITTER (1-855-774-8837).

A machined and highly polished ball allows easy turning of the handle using finger tips only – even under pressure.



TRUE UNION BALL VALVES

Finger Tip Flow Control

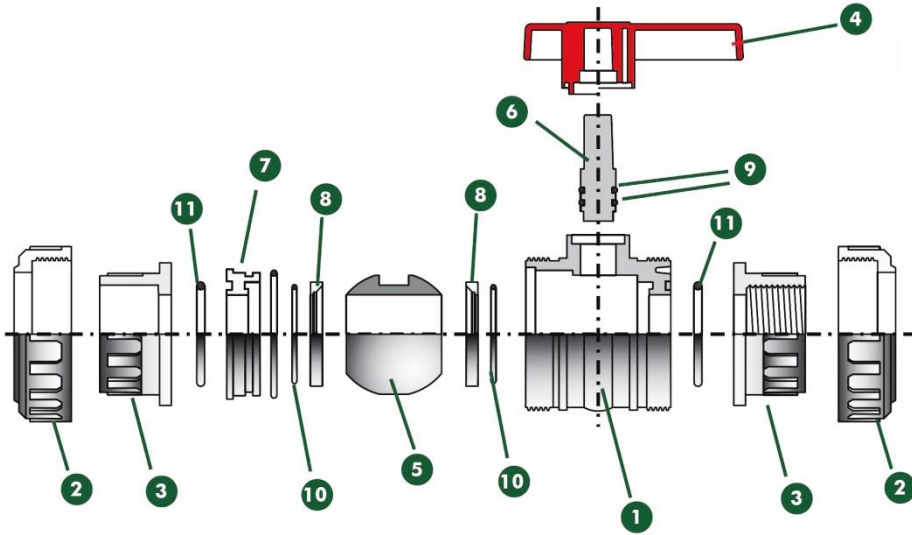

Fig.	Part	Material
1	Body	PVC
2	Union Nut	PVC
3	End Connector	PVC
4	Handle	ABS
5	Ball	PVC
6	Stem	PVC
7	Seal Carrier	PVC
8	Ball Seat	HDPE
9	Stem O-Ring	EPDM
10	Body O-Ring	EPDM
11	End Connector O-Ring	EPDM



The CEPEX ball valve is the only true union PVC ball valve with both the features and pricing that are practical for nursery use. Refer to the tables on this page for ordering information and a basic parts list. For more technical details or for information on other Primerus products, visit us at PrimerusProducts.com or call us at 1-855-SPITTER (1-855-774-8837).

ORDERING INFORMATION

Slip P/N	Threaded P/N	Description	Max Pressure
CP-MA2001	CP-MA2011	1/2" PVC Ball Valve, EPDM	240 psi
CP-MA2002	CP-MA2012	3/4" PVC Ball Valve, EPDM	240 psi
CP-MA2003	CP-MA2013	1" PVC Ball Valve, EPDM	240 psi
CP-MA2004	CP-MA2014	1-1/4" PVC Ball Valve, EPDM	240 psi
CP-MA2005	CP-MA2015	1-1/2" PVC Ball Valve, EPDM	240 psi
CP-MA2006	CP-MA2016	2" PVC Ball Valve, EPDM	180 psi
CP-MA2008R	CP-MA2018R	3" PVC Ball Valve, EPDM , Reduced Port	180 psi
CP-MA2010R	CP-MA2020R	4" PVC Ball Valve, EPDM , Reduced Port	180 psi